



Installation Instructions

454 Night Latch

Instructions

1. Choose the desired height on the door for the night latch, and drill according to template below
2. Determine whether the lock is required for open-in or open-out, and reverse the latch if needed (see below)
3. Secure the night latch to the door
4. Apply strike to the door jamb lower than the centreline, leaving 2mm for any door sag

Reversing latch

1. Undo the screw to remove the backing plate
2. Remove the circlip under the latch, allowing the latch to be removed from the body
3. Rotate latch and replace circlip
4. Replace backing plate

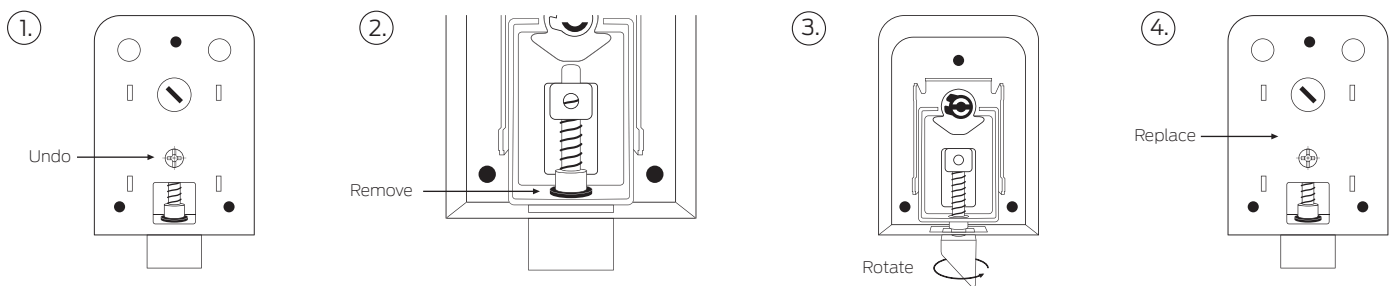

Template

